

TOWNSHIP 3 N., RANGE 8 W.W.M. TILLAMOOK COUNTY ORE.

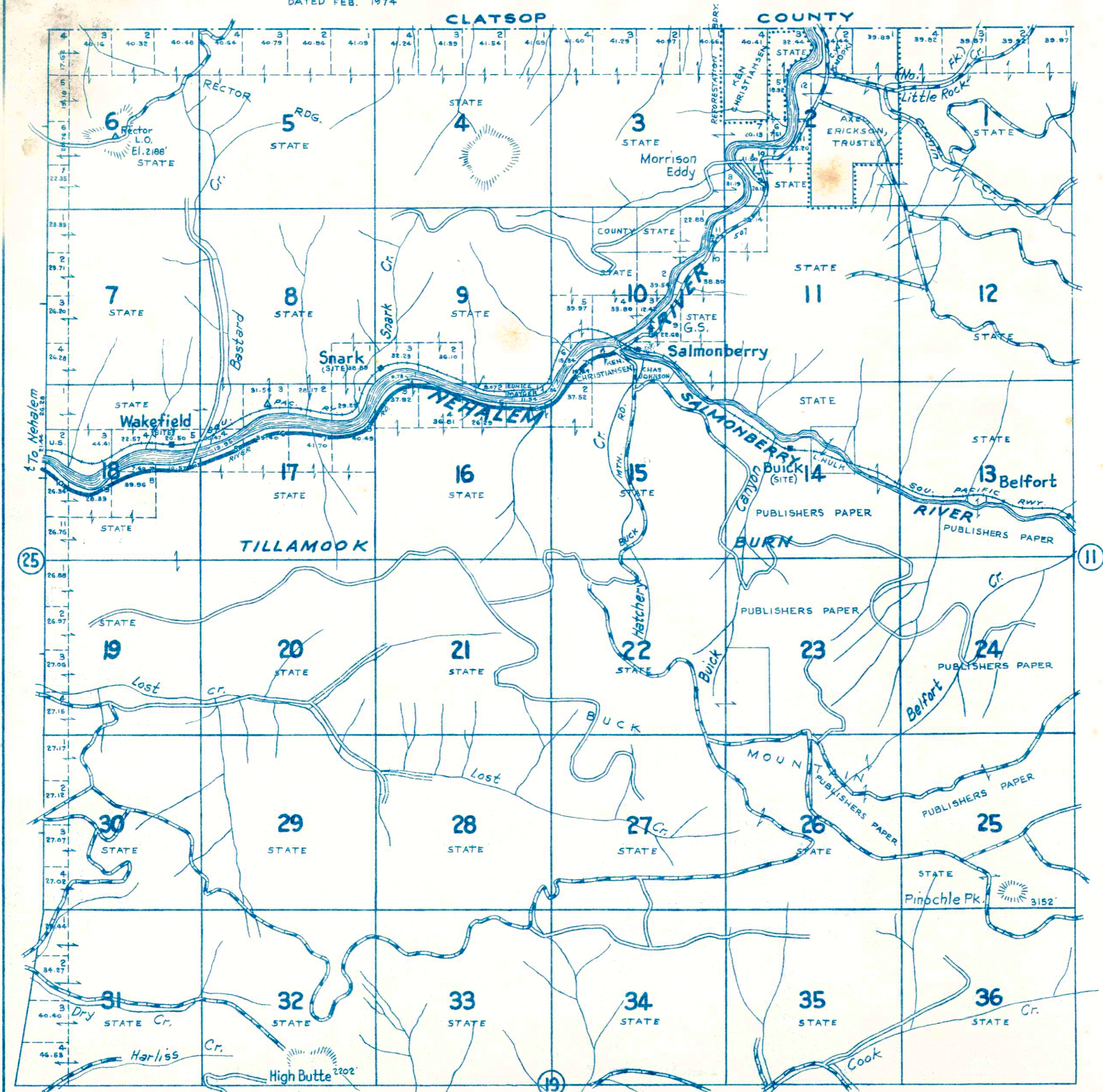

Reproduction in whole or part for personal use or resale is prohibited by law.

- LEGEND**
- STATE HWY. 6
 - PAVED HIGHWAYS
 - IMPROVED DIRT ROADS
 - DIRT ROADS
 - INFERIOR ROADS
 - RAILROADS
 - TRAILS
 - INTERMITTENT CREEKS
 - U.S. HWY. 101